

Indi Knee Joint



Features

Waterproof for all situations

Sizes available for the **smallest to largest** patients

Available with **long or short uprights**

+ Maximum **extension 5°** and **flexion 140°**

+ **Posterior offset** proportionally adjusted to joint size

+ **Noise dampener** with self-locking setscrew for higher patient acceptance

Additional functions with the **Strecker add-on**

Fabricated from **high-strength titanium**

Standard

Fully assembled as one item for clear cost estimates and uncomplicated ordering

Machined uprights and offset connection ensure **optimal transfer of force**

Upper section **CNC-machined from one piece** of material for increased stability

Precise assembly calibrated to 1/100mm with self-lubricating washers for smooth operation free of play

Maintenance-free stainless steel joint assembly with bronze bushing

Unrivalled **20-month guarantee**

Engraved **serial number** for traceability

Clearly illustrated instructions for use

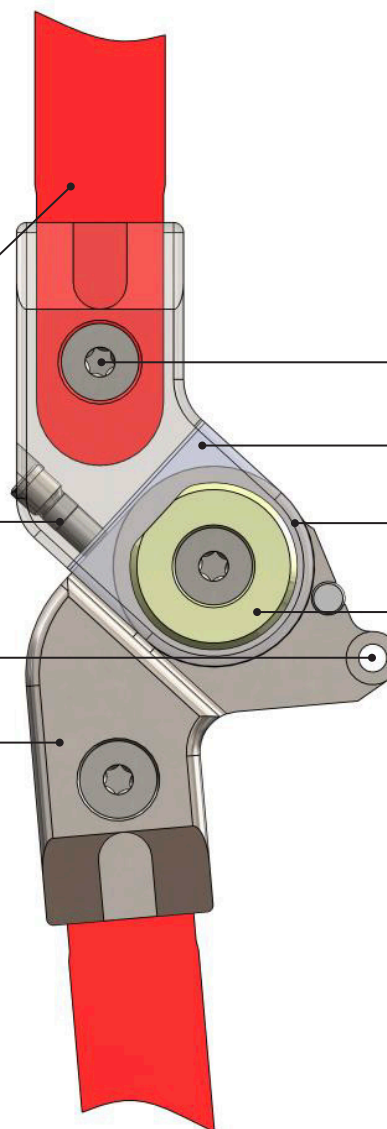
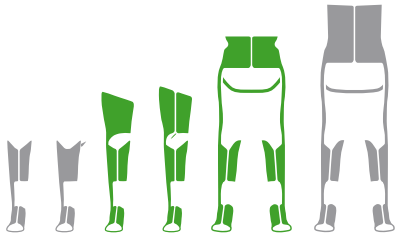
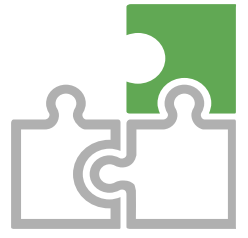

Fig. left



We recommend using our configurator to make your selection.
The configurator considers, among other factors, weight to height ratios.



Weight Classification (body weight)

Article No.	KAFO	HKAFO
Indi-22	not yet available	not yet available
Indi-25-Plus	not yet available	not yet available
Indi-28	not yet available	not yet available
Indi-30	up to 50 kg	up to 50 kg
Indi-30-Plus	up to 70 kg	up to 70 kg
Indi-34	not yet available	not yet available
Indi-34-Plus	not yet available	not yet available

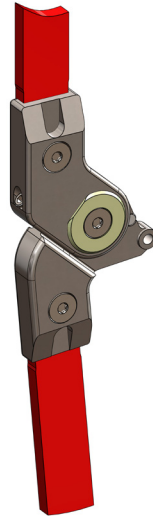

Joint

Length	Width	Thickness	Weight	Posterior Offset
–	–	–	–	–
–	–	–	–	–
–	–	–	–	–
112 mm	30 mm	16 mm	180 g	17,5 mm
112 mm	30 mm	16 mm	180 g	17,5 mm
–	–	–	–	–
–	–	–	–	–

Locked	Extension 5°	Flexion 115°	Posterior Offset	Modular	Force Options	No Grinding Necessary	Noise Dampening	Water Resistant H ₂ O
--------	-----------------	-----------------	------------------	---------	---------------	-----------------------	-----------------	-------------------------------------