

# Revo-1D Hip Joint



## Features

Sizes available for **infants to large** patients

Fabricated from **high-strength aluminium**

+ **Pre-select locking mechanism**  
with 2-step opening and closing

+ **Push button** unlocks joints, which open when hips are fully extended and tension on the locking pins relieved. To stand up, joints are placed in the locked position and automatically snap into place upon full hip extension

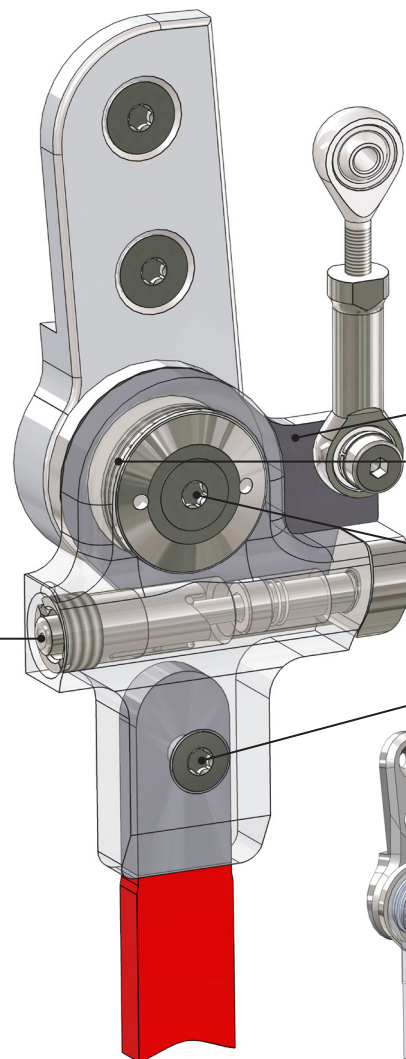

Fig. left

## Standard

**Fully assembled** as one item for clear cost estimates and uncomplicated ordering

**Secure and adjustable** connection to pelvic band

Movement is transferred via connectors and rocker bar mechanism to the contralateral side, enabling **reciprocal gait**.

**Rigid** stainless steel connecting plate cannot be bent

**Long-life** thrust bearings for smooth operation free of play

**Maintenance-free**, high-strength steel joint assembly with brass bushing

Machined upright and offset connection ensure **optimal transfer of force**

+ **Revo-infant** uses a **lever mechanism** for added security with smaller patients

Unrivalled **20-month guarantee**

Engraved **serial number** for traceability

**Clearly illustrated** instructions for use

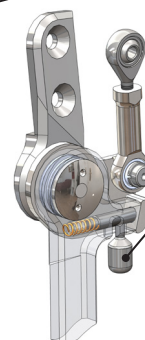

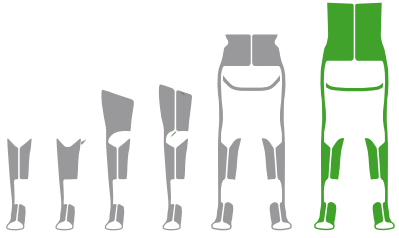

We recommend using our configurator to make your selection.  
The configurator considers, among other factors, weight to height ratios.

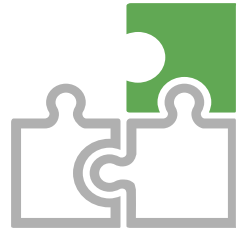

### Weight Classification (body weight)

Article No.	RGD
Revo-1D-infant	up to 15 kg
Revo-1D-klein	up to 25 kg
Revo-1D-mittel	up to 50 kg
Revo-1D-groß	up to 65 kg
Revo-1D-ex-groß	up to 85 kg

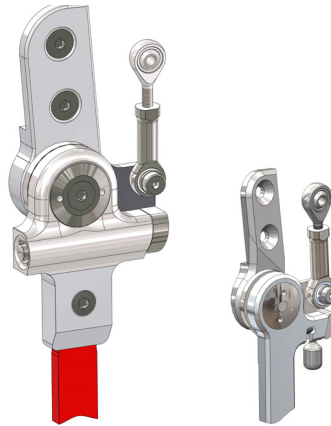

Revo-klein- to ex-groß      Revo-infant

### Joint

Width	Thickness	Height
28 mm	23,0 mm	91,0 mm
35 mm	28,0 mm	134,0 mm
35 mm	28,0 mm	142,0 mm
35 mm	32,0 mm	142,0 mm
35 mm	32,0 mm	144,0 mm



Locked



Extension



Flexion

Step Length

with Pelvic Rotation

Abduction



and Adduction



No Grinding  
Necessary